

---

# TAN.EASY

## PRO TOOLS

---

### OPERATION MANUALS

TAN.EASY SPRAY GUNS - HANDY.TAN - TAN.LITE 32000 -  
TAN.EXPERT TOWER 38000 - TAN.FRESH.AIR PORTABLE UNIT  
- TAN.FRESH.AIR DOUBLE FAN UNIT - TAN.EASY SCREEN -  
TAN.EASY SCREEN WITH EXTRACTION - TAN.BOOTH WITH  
EXTRACTION - ALL.IN.ONE TAN.BOOTH

### CONTENTS

---

#### SPRAY GUNS

1. TAN.EASY SPRAY GUNS

#### MACHINES

2. HANDY TAN

3. TAN.LITE 32000

4. TAN.EXPERT TOWER 38000

#### EXTRACTION

5. TAN.FRESH-AIR PORTABLE UNIT

6. TAN.FRESH-AIR DOUBLE FAN UNIT

#### SCREENS

7. TAN.EASY.SCREEN

8. TAN.EASY.SCREEN WITH EXTRACTION

#### BOOTH

9. TAN.BOOTH EXTRACTION

10. TAN.BOOTH ALL.IN.ONE

11. WARRANTY & GUARANTEE

12. WARNING & SAFETY

## OPERATION MANUAL

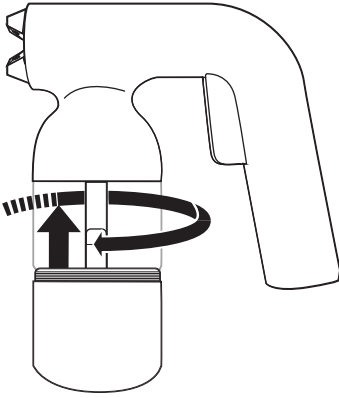

### SETTING SPRAY PATTERN

Adjusting the spray-pattern nozzle of your Handy.Tan to suit your preferred style of spray tanning.

#### SPRAYING SIDE TO SIDE ACROSS THE BODY

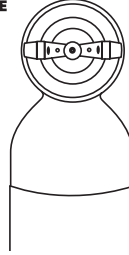
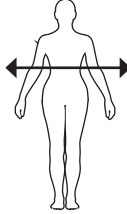

Set the nozzle fan 'Horizontal'. This spray pattern is perfect for spraying side to side ie. left to right - right to left across the body.

#### SPRAYING UP & DOWN THE BODY

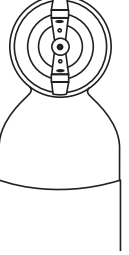
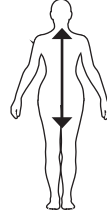

Set the nozzle fan Vertical. This spray pattern setting is perfect for spraying up and down, top to bottom of the body.

## OPERATION

1. Un-screw the external solution cup away from the Handy.Tan and fill desired amount of spray solution. We recommend filling it a minimum of half way for best results. Over filling the solution cup may cause leaks.
2. Screw Cup back into the Handy.Tan. Ensure it is fully tightened so no leaks occur.

### QUICK CONNECT

#### ATTACHING AIR HOSE

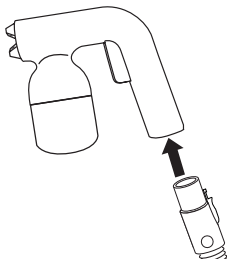

Attach the air hose by inserting the end of the air-hose into the bottom of the handle of the handy tan. Push the click to connect fitting into the handle of the handy tan until you hear a click.

#### REMOVING AIR HOSE

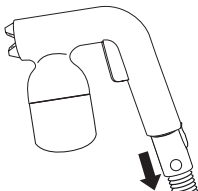

To remove the air hose, push down with your thumb on the click to connect button and pull downward

### TWIST CONNECT

#### ATTACHING AIR HOSE

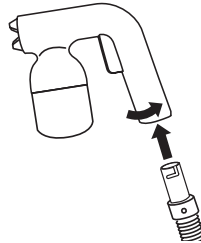

Attach the air hose by inserting the end of the air-hose into the bottom of the handle of the handy tan. Turning it anti-clockwise until firm will secure the fitting inline with your Handy Tan.

#### REMOVING AIR HOSE

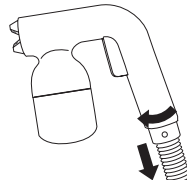

To remove the air hose, turn the hose clockwise to unlock the hose and remove it from the Handy Tan.

## SETTING SOLUTION AIR-FLOW CONTROL

The solution Flow Control dial on the back of the applicator will determine how much solution will be dispensed from the gun. You can adjust the flow of solution by adjusting the dial on the handle.

The higher number on your dial, the more solution will flow from the HandyTan. As you become more comfortable with your spray tan techniques, you can increase the flow of your solution.

**MAXIMUM SOLUTION FLOW**

**MINIMUM SOLUTION FLOW**



DECREASE SOLUTION

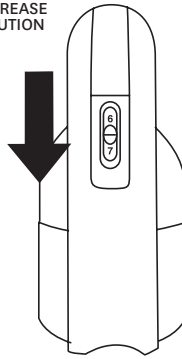

INCREASE SOLUTION

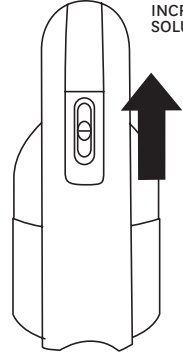

## CLEANING & MAINTENANCE:

### EXTERNAL SOLUTION CUP

Rinse your solution cup with warm water until clean. Wipe all areas dry ready for the next use.

**Please note:** We recommend washing your cup under water, each time you remove the cup from the handy tan and refill. If you have spilled the contents of the cup and product gets in the screwband (grooved area of the cup being screwed into the HandyTan) simply wipe the grooves with Tan.Easy Cleaning Wipes or a wet cloth/paper towel. This will allow the cup to be easily tightened back onto the HandyTan and cause the cup not to leak excess spray solution.

### AIR HOSE

Wipe the Air Hose daily with Tan.Easy Cleaning Wipes. Alternatively use a damp cloth. Once dry, store in a clean dry place.

### HANDY TAN **IMPORTANT!** We recommend doing this over a sink or towel.

1. Remove the hose from the HandyTan.
2. Unscrew the cup from the HandyTan and empty any un-used solution from the cup.
3. Rinse the empty solution cup with warm water until clean and then fill the cup about  $\frac{1}{4}$  full of warm water.
4. Insert the cup and screw tightly, back into the HandyTan and re-connect the hose.
5. Turn on your spray tan machine and adjust your solution Flow Control dial to the highest setting for maximum water spraying.
6. Direct the spray applicator into the sink and spray the clean water through until the cup is empty. This will clean through the needle and out to the spray-pattern nozzle.
7. Now that the cup is empty, re-set your solution Flow Control dial on the back of the HandyTan to your regular settings.
8. Disconnect the HandyTan from the Air-Hose and unscrew the cup.
9. Wipe all areas dry including the cup and HandyTan ready for the next use.

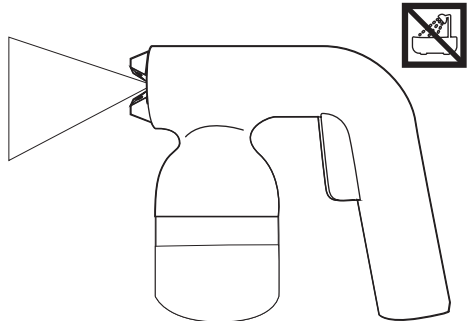

**IMPORTANT!** You must not submerge the HandyTan under water. If your handy tan has excess spray solution, wipe down with Tan.Easy Clean Wipes. Alternately you can use a smooth cloth (avoid anything abrasive) with a general glass cleaner to maintain the gloss finish.

## OPERATION MANUAL

### ASSEMBLY

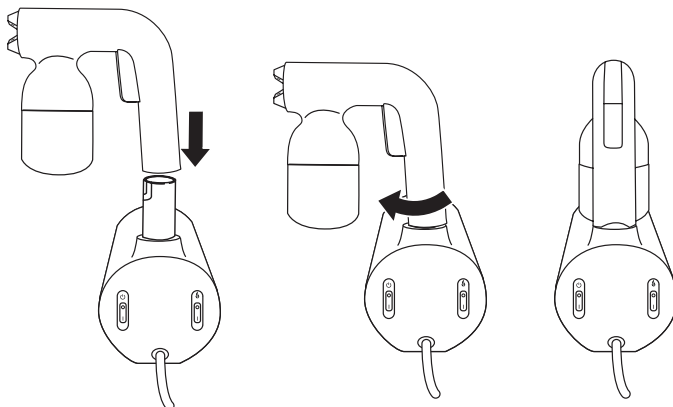

1. To begin, attach the Handy Tan mini-compressor by inserting the bottom of the handle of the handy tan into the connector of the mini-compressor.
2. Turn it clockwise until firm will secure the spray gun to the mini-compressor. This will lock the spray gun firmly into place.

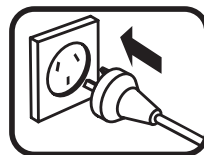

Once the Spray gun is attached to the mini compressor, Insert the power cord into the device and in the wall plug and turn power on at the wall switch.

### REMOVING THE SPRAY GUN

To remove the handy tan mini-compressor for cleaning and refilling solution cup, turn the spray gun anti-clockwise to unlock and remove it from the mini-compressor.

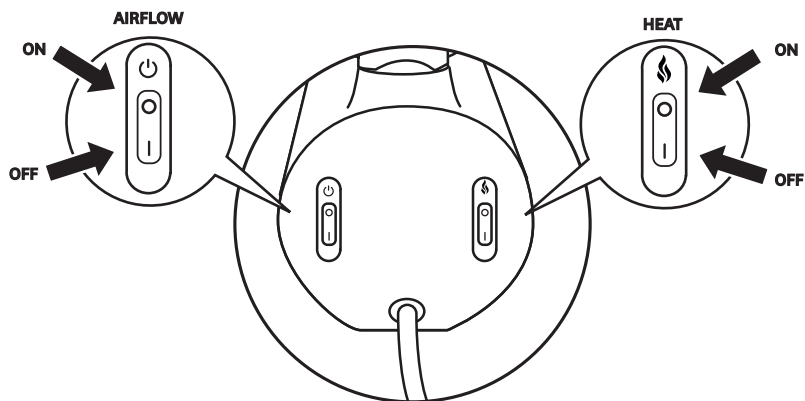

REGISTER YOUR  
12 MONTH GUARANTEE



## OPERATION MANUAL

### ASSEMBLY

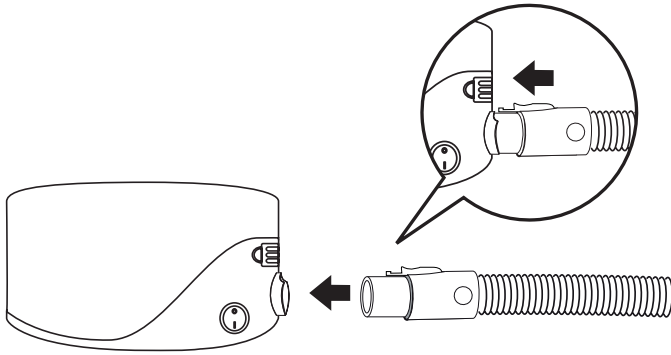

1. To begin, attach the hose with the 'quick-connect' style fitting.
2. To remove the air hose easily, push down on the button located on the collar of the quick-connect fitting and remove the hose.

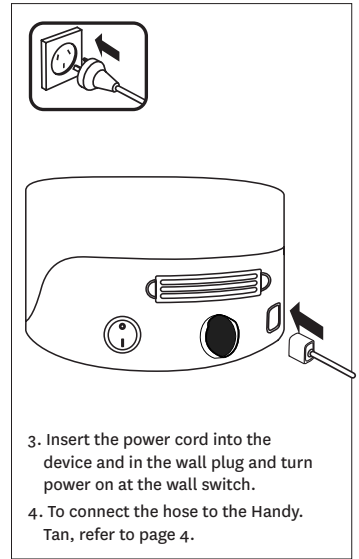

3. Insert the power cord into the device and in the wall plug and turn power on at the wall switch.
4. To connect the hose to the Handy.Tan, refer to page 4.

### OPERATION

#### POWER ON : Airflow with Intelligent Air-Smart Control

Turn the device 'on' by pressing the on switch. The Tan.Lite 32000 has an intelligent Air-Smart Switch set for the perfect airflow coming from the device into the Handy.Tan Spray Gun. This creates flawless spray tanning results every time.

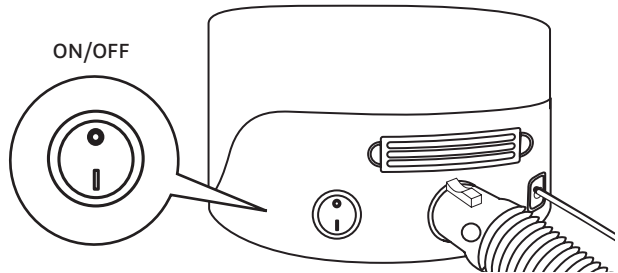

**REGISTER YOUR  
2 YEAR GUARANTEE**



# TAN.EXPERT TOWER 38000

## OPERATION MANUAL

### ASSEMBLY

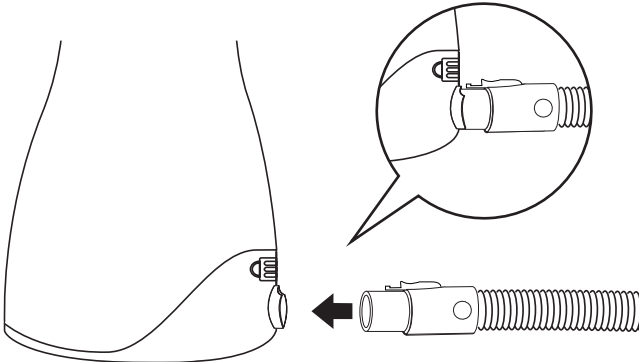

1. To begin, attach the hose with the 'quick-connect' style fitting.
2. To remove the air hose easily, push down on the button located on the collar of the quick-connect fitting and remove the hose.

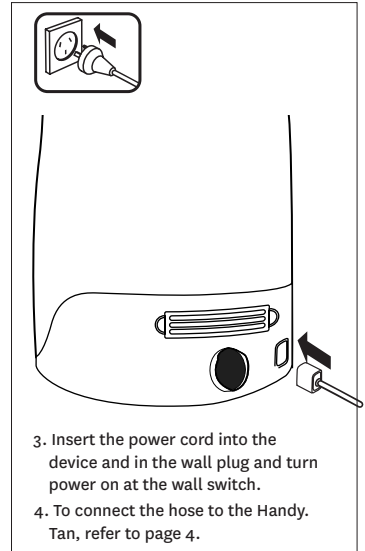

3. Insert the power cord into the device and in the wall plug and turn power on at the wall switch.
4. To connect the hose to the Handy.Tan, refer to page 4.

### OPERATION

#### POWER ON : Airflow with Intelligent Duel Air-Smart Control

Turn the device 'on' by pressing the on switch on the top of the device. The Tan Expert Tower 38000 has an intelligent Duel Air-Smart Switch set for the perfect airflow coming from the device into the Handy.Tan Spray Gun.

To Change the airflow speed press the Air-Smart Switch control button.

I indicate a 'medium' Airflow speed,  
II indicates a 'high' Airflow speed.

This creates flawless spray tanning results every time.

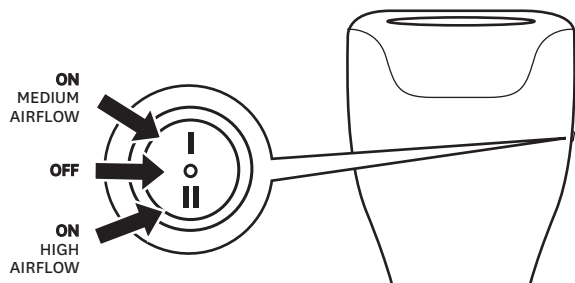

## REGISTER YOUR 2 YEAR GUARANTEE



## CLEANING & MAINTENANCE TAN.LITE & TAN.EXPERT TOWER:

# IMPORTANT

**WASH TURBINE FILTER  
WITH WATER AT LEAST  
EVERY 6 MONTHS**



### SPRAY MACHINE



If the spray machine gets dirty with overspray solution, wipe down with Tan.Easy Cleaning Wipes. Alternatively you can use a smooth cloth (avoid anything abrasive) with a general glass cleaner to maintain the gloss finish.

**WARNING: ALWAYS UNPLUG  
THE DEVICE BEFORE CLEANING.**



### WASHING YOUR TURBINE FILTER

The only maintenance necessary on the Tan.Lite & Tan.Expert device is cleaning or changing the turbine filter.

1. Remove the turbine filter from the filter housing located above the air hose 'Turn&Lock' screw connect.
2. Wash under cold water. Do not use detergents to clean the filter.
3. Please leave to dry completely.

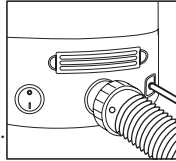

**Consideration:** The filter may require more frequent washing if product is located close to spraying.

**Please Note:** We recommend your spray machine be placed a minimum of 50cm behind you. This ensures minimum cleaning with your machine. HVLP technology recirculates air from the environment. With your machine by your side, spray tan solution will be sucked back into the filter of your spray machine, clogging up the filter in the machine, meaning more frequent cleaning. Positioning the spray unit behind you will ensure the unit stays cleaner for longer.

**IMPORTANT!** It is important to check your filter and wash at least every 6 months, according to instructions, to maintain performance. Do not put the filter in a dishwasher, washing machine, tumble dryer, oven, microwave or near

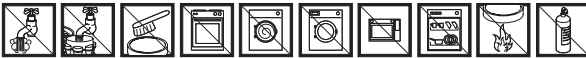

# TAN.FRESH-AIR PORTABLE UNIT

## OPERATION MANUAL

### OPERATION

#### POWER ON : Extraction & Clean Air with Micro Whirlwind Technology

Turn the device 'on' by pressing the red on switch located on the Tan.Fresh Air Unit.

By Turning the unit on, the Micro-Whirlwind extraction fan will help remove overspray in the air of any room when spray tanning.

The Tan.Fresh Air Series of clean air extraction systems works by extracting the moisture (and any troublesome tanning solution) from the air before it travels throughout the room.

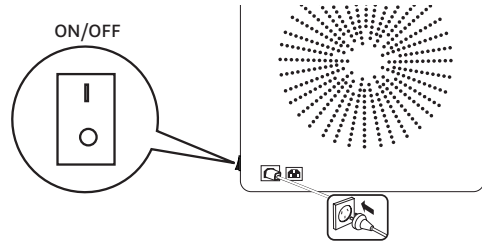

### CLEANING & MAINTENANCE:

#### REPLACING THE FRESH AIR FILTER

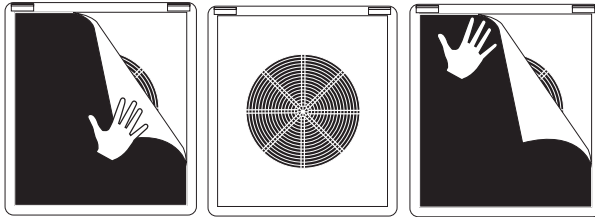

**IMPORTANT!** Do not turn the filters back to front to try and re-use the other side. They will only work based on one air flow direction. It is important to check your filter and replace according to instructions, to maintain performance. Do not put the filter in a dishwasher, washing machine, tumble dryer, oven, microwave or near a naked flame. Dispose of filter once used.

The Tan.Fresh Air filter captures any fine mist and reduces mess to ensure the environment is comfortable for both clients & the user.

1. Switch off power supply to ensure the Tan.Fresh Air Unit is not in operation.
2. Peel back the filter from one corner of the Tan.Fresh Air Unit.  
(We recommend using gloves to keep hands clean)
3. Dispose of the old filter.
4. Using your hands carefully slide new filter into the lip created by the frame and evenly work the filter into position using your hands.

**IMPORTANT 100**  
FULL BODY APPLICA-

REPLACE EACH TAN.FRESH AIR FILTER AFTER 100 SPRAY TANS (FULL BODY APPLICATION) OR AFTER 5 LITRES (169 FLOZ) OF PRODUCT

#### TAN.FRESH AIR UNIT



If the Tan.Fresh Air Unit gets dirty with overspray solution, wipe down with Tan.Easy Cleaning Wipes. Alternatively you can use a smooth cloth (avoid anything abrasive) with a general household glass cleaner to maintain its clean finish.

**WARNING: ALWAYS UNPLUG THE DEVICE BEFORE CLEANING.**



**REGISTER YOUR  
2 YEAR GUARANTEE**





# TAN.FRESH-AIR DOUBLE FAN

## OPERATION MANUAL

### OPERATION

#### POWER ON : Extraction & Clean Air with Micro Whirlwind Technology

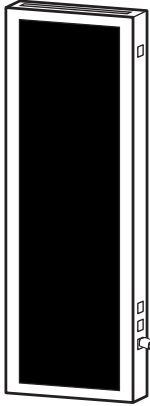

By Turning the unit on, the Micro-Whirlwind extraction fan will help remove overspray in the air of any room when spray tanning.

The Tan.Fresh Air Series of clean air extraction systems works by extracting the moisture (and any troublesome tanning solution) from the air before it travels throughout the room.



#### DOUBLE FAN UNITS ARE USED IN THE TAN.BOOOTH

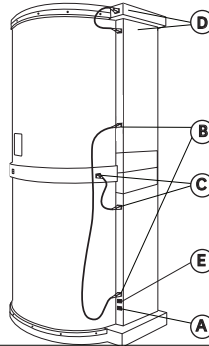

- A - connects power cord
- B - connects the top and bottom fans
- C - connects middle to bottom fan
- D - connects top fan to top light

#### ALL.IN.ONE.BOOOTH

- E - additional connecting cord connects bottom fan to Tan. Lite (All-in-One Booth only).

### CLEANING & MAINTENANCE:

#### REPLACING THE FRESH AIR FILTER

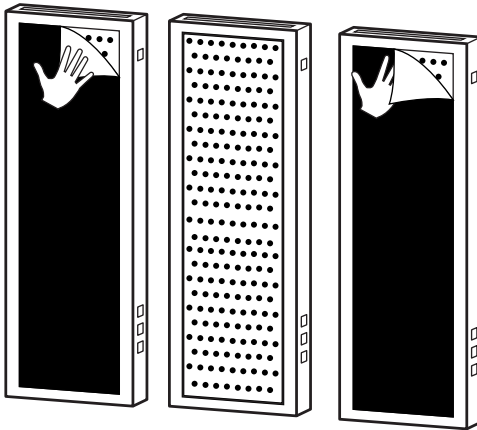

The Tan.Fresh Air filter captures any fine mist and reduces mess to ensure the environment is comfortable for both clients & the user.

1. Switch off power supply to ensure the Tan.Fresh Air Unit is not in operation.
2. Peel back the filter from one corner of the Tan.Fresh Air Unit.  
(We recommend using gloves to keep hands clean)
3. Dispose of the old filter.
4. Using your hands carefully slide new filter into the lip created by the frame and evenly work the filter into position using your hands.

**REGISTER YOUR  
2 YEAR GUARANTEE**



# TAN.SCREEN

## OPERATION MANUAL

### REMOVING FROM PACKAGING

**IMPORTANT!** It is essential for the Tan.Screen to be removed correctly to avoid the black panels from falling out and the Aluminum frame not being level and secure. If the Frame is not secure, it will not be level when assembled.

Steps to remove the Tan.Screen from it's box correctly:

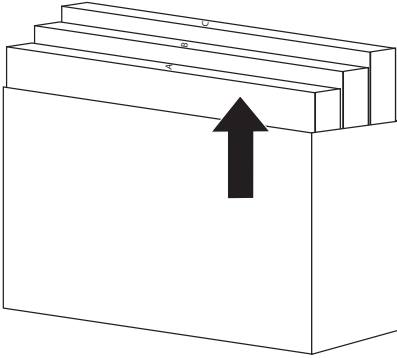

1. You must remove BOX A, B & C from its outer carton first.

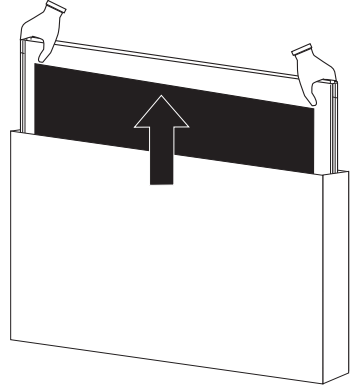

2. Remove each screen section from it's box, ensuring you use both hands and pull out of the box holding each left and right corner of the frame.

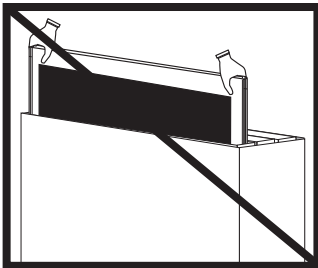

DO NOT REMOVE EACH TAN.SCREEN SECTION FROM THE OUTER CARTONS OF THE BOX

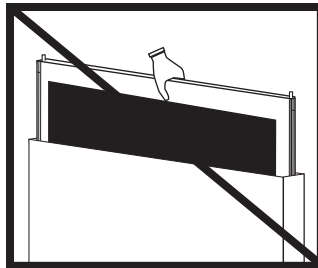

DO NOT USE ONE HAND TO REMOVE THE TAN.SCREEN SECTION OUT OF THIS BOX.

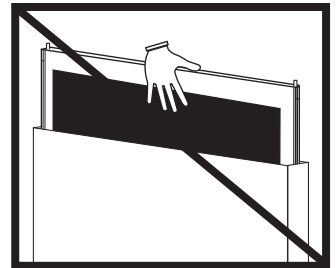

DO NOT REMOVE TAN.SCREEN SECTION HOLDING THE BLACK PANEL.

IF THE FRAME APPEARS TO BE NOT LEVELED OR THE BLACK PANELS HAVE BECOME LOOSE PLEASE REFER TO PAGE 7 OF THIS MANUAL : CHANGING THE PANELS & LEVELED OUT THE ALUMINUM FRAME.

**REGISTER YOUR  
2 YEAR GUARANTEE**



## ASSEMBLY: TAN SCREEN

There are 3 x Screen sections that make up the final Tan.Screen. This is labeled on each box (Outer Carton). Each screen section is to be assembled in order A (Bottom Piece)-B (Middle) and then C(Top Piece).

**TIP:** There are two sides of the screen. The back contains the seal. The seal is located around the black panel. Make sure this side faces to the back.

### REFER TO DIAGRAM:

1. To begin, open the package and position the Tan.Screen in your salon or space. Allow for the necessary room around the unit for free movement and enough room at the back of the screen to get access to.
2. Start with Screen Section A. Place Screen Section B onto Screen Section A. Each section simply stacks on top of each other by the metal posts.
3. Simply slot Section B into A.
4. Slot Section C in B.

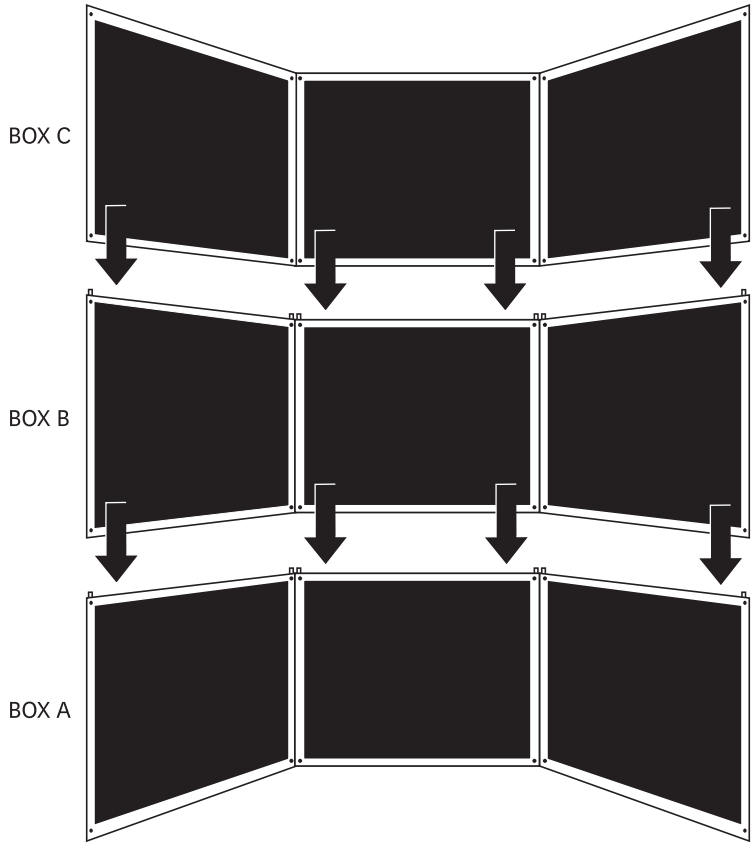

### SLOTING EACH SCREEN PANEL TOGETHER:

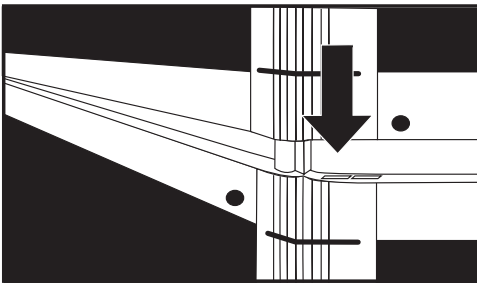

### SECURED IN PLACE:

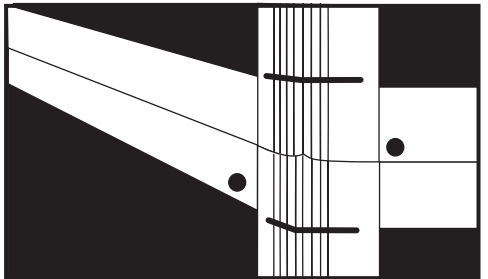

Each section simply slots into one another as shown below. The Aluminum Frame will be level and secure in place. Please note: No screwing or tightening is needed. If the panels are not level and fit in place, please refer to Page 7 of this manual **ASSEMBLY: ALUMINUM FRAME: CHANGING THE PANELS & LEVELING OUT THE ALUMINUM FRAME.**

# TAN.SCREEN WITH EXTRACTION

## ASSEMBLY: TAN FRESH AIR SCREEN WITH EXTRACTION

There are 3 x Screen sections that make up the final Tan.Screen. This is labeled on each box (Outer Carton) Each screen section is to be assembled in order A (Bottom Piece)-B (Middle) and then C(Top Piece).

TIP: There are two sides of the screen. The back contains the seal. The seal is located around the black panel. Make sure this side faces to the back.

### REFER TO DIAGRAM:

1. To begin, open the package and position the Tan.Screen in your salon or space.  
Allow for the necessary room around the unit for free movement and enough room at the back of the screen to get access to.
2. Start with Screen Section A.  
Place Screen Section B onto Screen Section A.  
Each section simply stacks on top of each other by the metal posts.
3. Simply slot Section B into A.
4. Slot Section C in B.

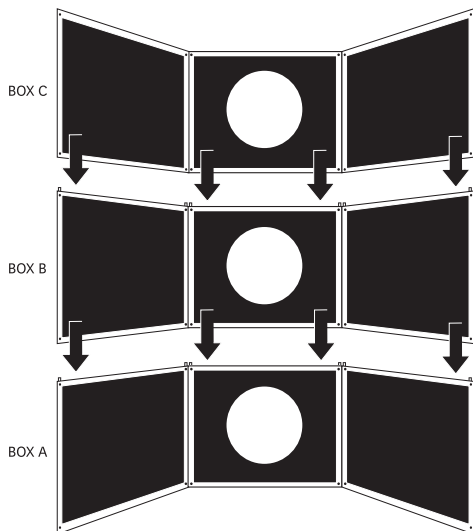

### REFER TO DIAGRAM:

1. To attach each Tan.Fresh Air Unit, go to the back on the Tan.Screen and locate the open slots at the top of each center screen section.
2. Insert the Tan.Fresh Air fan unit in each slot to fix into screen as pictured.

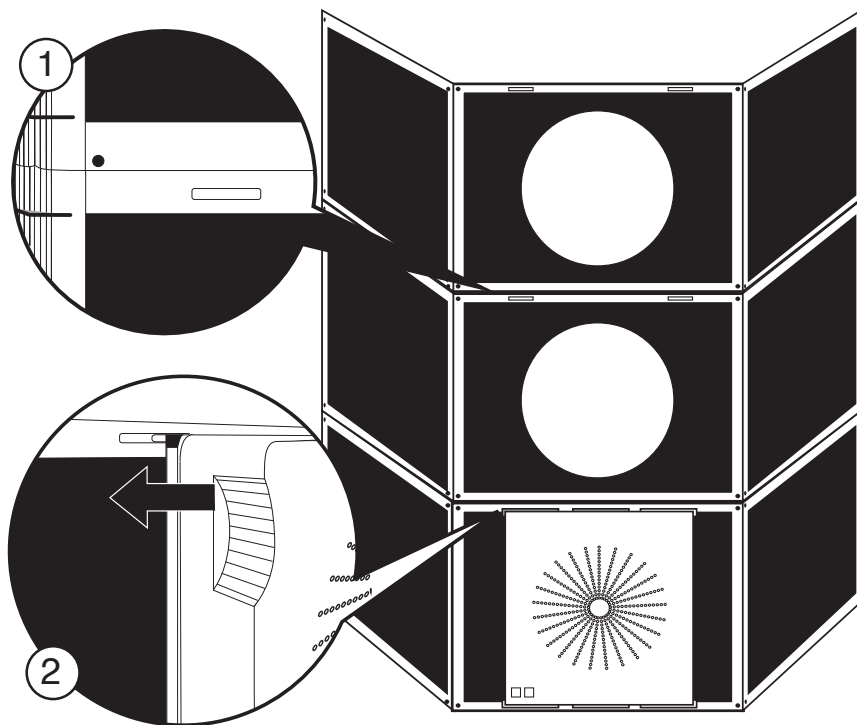

## ASSEMBLY: TAN FRESH AIR FANS

All 3 fans can be piggy-backed onto one another. Simply attach all 3 fans to the back of the screen. Then connect all fans to the back of the fan with the main power source using the connecting cords provided. It is best to use the bottom fan as the main power source for safety and ease of use.

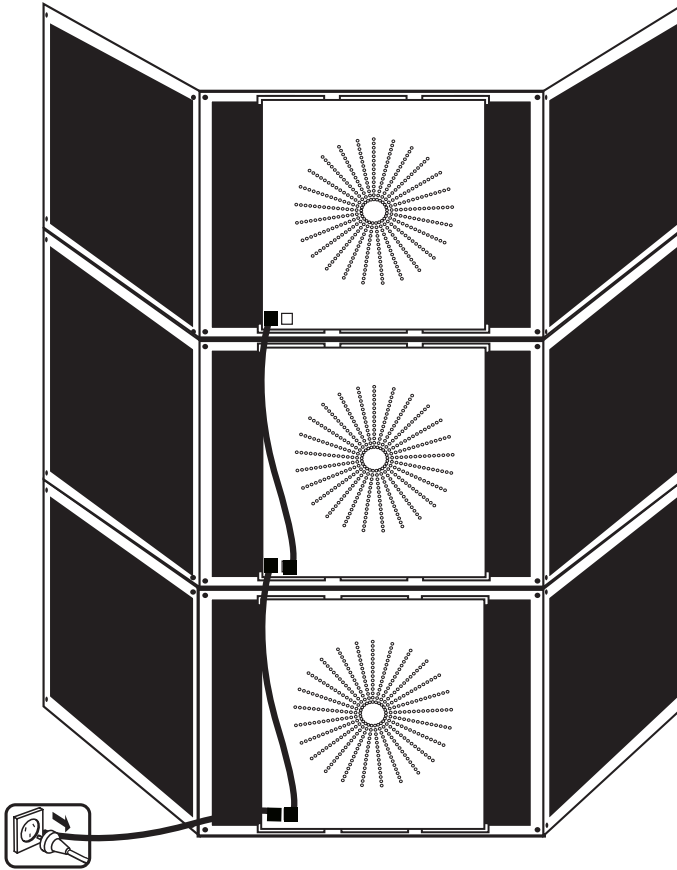

## IMPORTANT SAFETY PRECAUTIONS

SAVE THESE INSTRUCTIONS. THIS PRODUCT IS INTENDED FOR PROFESSIONAL USE ONLY. BEFORE USING THIS TAN.EASY PRODUCT, READ ALL INSTRUCTIONS AND CAUTIONARY MARKINGS IN THIS MANUAL AND ON THE DEVICE.

1. Adult assembly required. Never let small children near this product.



Do not use near open flames

## IMPORTANT

WIPE DOWN TAN.  
SCREEN WITH A DAMP  
CLOTH AFTER USE.



## CLEANING & MAINTENANCE



If the Tan.Screen gets dirty with overspray solution, wipe down with Tan.Easy Cleaning Wipes. Alternatively you can use a smooth cloth (avoid anything abrasive) with a general household glass cleaner to maintain its clean finish.

# TROUBLESHOOTING

If you experience problems with your Tan.Easy Pro Tools device, in the first instance please read carefully through this Trouble Shooting section. If you cannot solve your problem please contact us for assistance. If you have further issues, please fill in a warranty claim at [taneasyprottools.com](http://taneasyprottools.com)

## PROBLEM

The Black Panels have become loose or have fallen out.

## REASON

- The Tan.Screen Section has not been removed from the box correctly
- The Panel has become loose in transit
- The Aluminum Frame has become loose and needs to be tightened.

## ACTION

Refer to Page 7 of this Manual: Assembly: Alluminum Frame.

## PROBLEM

The Tan.Screen does not appear level and straight when assembled.

## REASON

- The Aluminum Frame has become loose and needs to be tightened.

## ACTION

Refer to Page 7 of this Manual: Assembly: Alluminum Frame.

## PROBLEM

My Screen will not fit together correctly and I have metal posts sticking out at the top and bottom.

## REASON

- Each section has not been stacked correctly
- Some Sections have been stacked with front facing or back facing.

## ACTION

- Ensure you have stacked each section correctly, Section 'A' being on the bottom, Section 'C' being the top.
- Ensure each section is facing all the same way (Front & Back) when stacking on each other.
- Refer to Page 4 of this Manual: Assembly : Tan.Fresh Air Screen.



# TAN. BOOTH EXTRACTION

## OPERATION MANUAL

### COMPONENTS LIST

#### EXTRACTION BOOTH COMPONENTS

Quantity	Parts
1	Base
1	Top
2	Double Fans
1	Middle
2	Middle Fan Joints
2	Bottom Side Panels
2	Top side Panels
20	Screws
20	Washers
1	Power Cord (a)
3	Connecting Cords (b, c, d)



1x Power Cord (a)



3x Connecting Cords (b, c, d)



1x Middle



2x Middle Fan Joints

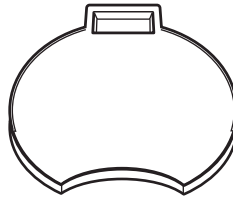

1x Base

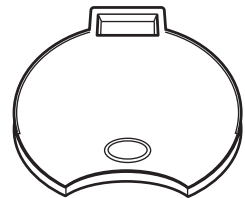

1x Top



20x Screws



20x Washers

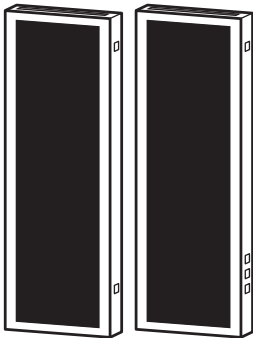

2x Double Fans

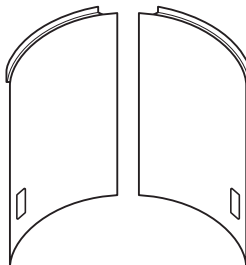

2x Top Side Panels

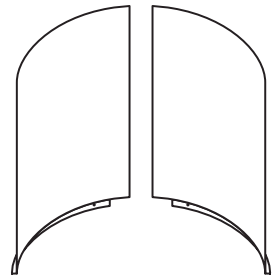

2x Bottom Side Panels

REGISTER YOUR  
2 YEAR GUARANTEE



TRUBLE-FREE WARRANTY  
2 YEAR  
GUARANTEE

## ASSEMBLY

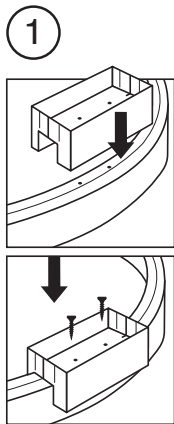

1. Place one middle fan joint onto the middle support section, ensure the screw holes are closest to the back. Use two screws with washers to join the parts.

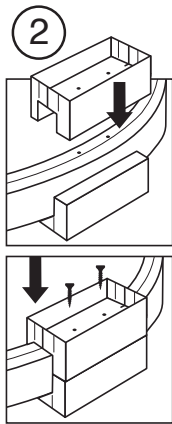

2. Turn over and repeat the process with the other middle fan joint.

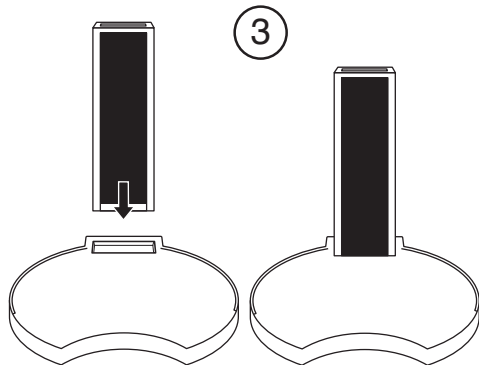

3. Slot the fan into the base piece.

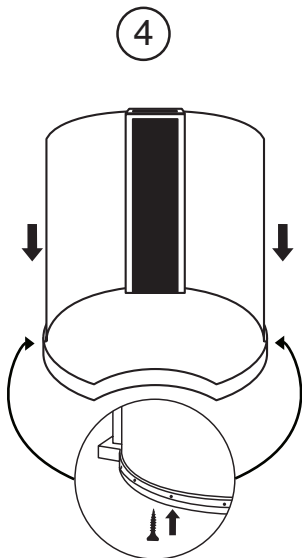

4. Insert side panels into the side of the fan and use 8 screws with washers to join the side panels to the base.

**IMPORTANT:** start with the screws at the front of each panel. Second person should stabilise fan and side walls whilst attaching screws.

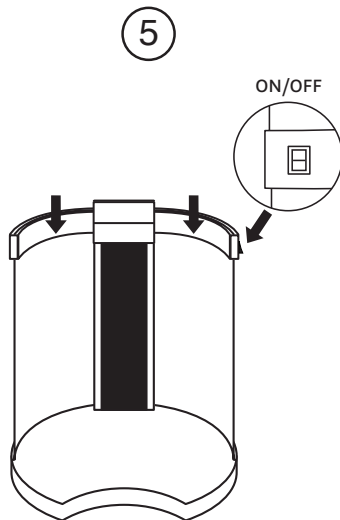

5. Place the middle section over the fan and slot over the side panels.

**IMPORTANT:** Ensure the switch is on the right-hand side.

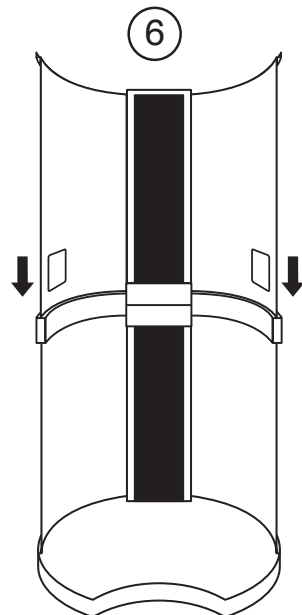

6. Insert the second fan into the back of the middle section. Insert each of the top side panels.

**IMPORTANT:** One person should hold the fan in place.



7

7. Lift the top section onto the fan. One person should hold the top in place whilst the other person fixes one screw with washer on the front of each side. Then Fix the remainder 6 screws and washers into place. Once all screws are in place you can connect all power cords and turn the unit on at the switch on the right hand side.

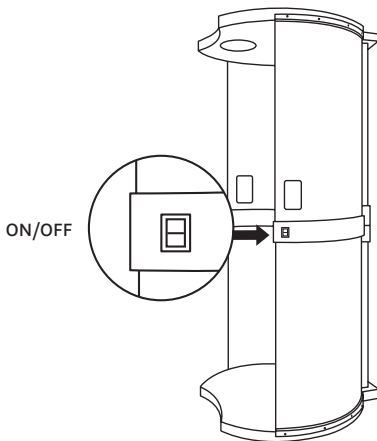

## POWER CONNECTIONS

- A - connects power cord
- B - connects the top and bottom fans
- C - connects middle to bottom fan
- D - connects top fan to top light

### ALL.IN.ONE.BOOTH

- E - additional connecting cord connects bottom fan to Tan.Lite (All-in-One Booth only).

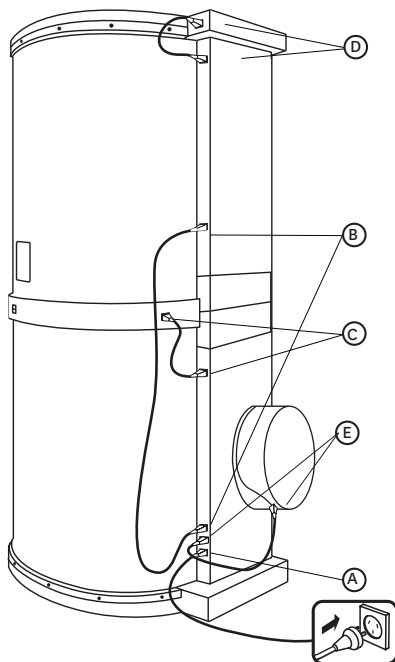

**IMPORTANT:** Connect the power cord (A) last after you have connected all the other cords.

# TAN.BOOOTH ALL.IN.ONE

The TAN.BOOOTH ALL.IN.ONE is the complete salon unit.

1. Attach the Tan.Easy Tan.Lite to the back of the booth as permanent fixture.
2. Attach the gun and hose to the Tan.Lite using the Quick Connect connection.
3. To minimise the use of power outlets, the Tan.Lite is easily connected to the Tan.Booth power source using a connecting cord.

## ALL.IN.ONE BOOTH ADDITIONAL COMPONENTS

Quantity Parts

- |   |  |
|---|--|
| 1 | Tan.Easy – Tan.Lite                              |
| 1 | Tan.Easy – Hose (Quick Connect)                  |
| 2 | Tan.Easy – Excess Applicators<br>(Quick Connect) |
| 1 | Connecting Cord                                  |

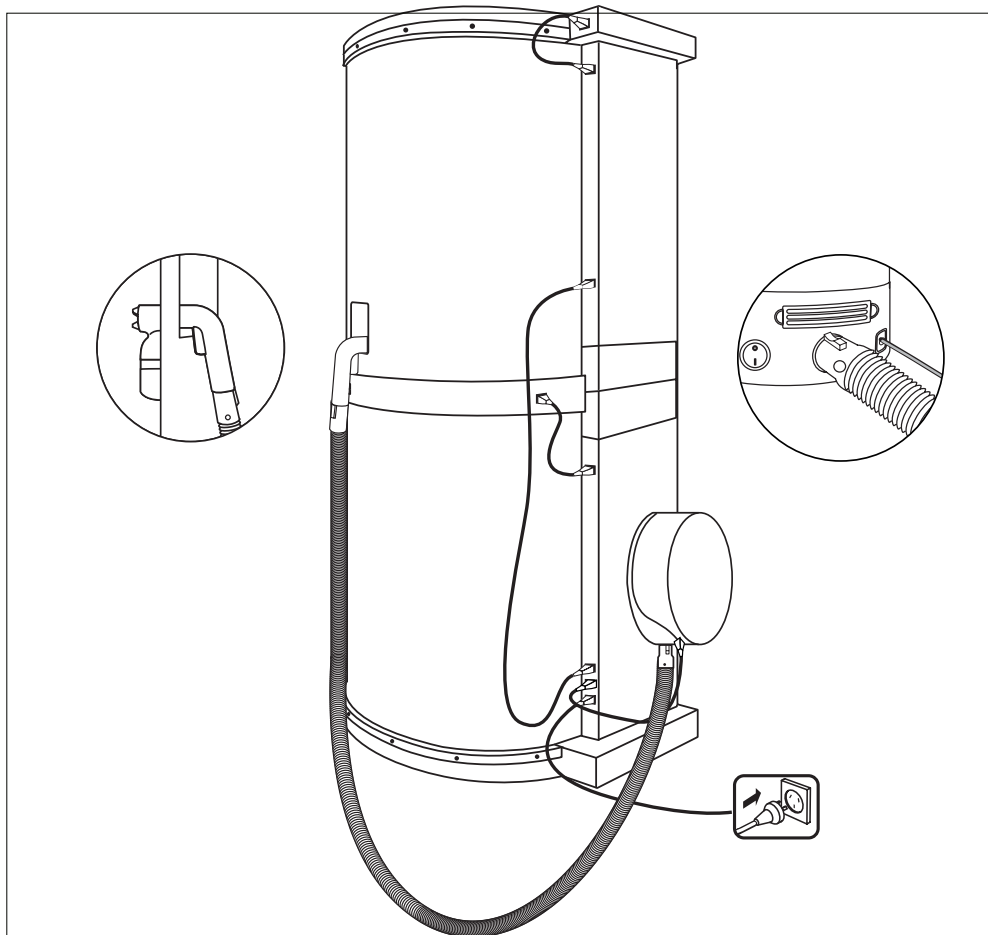

# WARRANTY & GUARANTEE

---

## TAN.EASY GUARANTEE

### 2 YEAR TROUBLE FREE WARRANTY

Congratulations on your purchase. We trust you will be happy with your purchase as the products are designed to give you many years of service.

To activate your Guarantee, please complete the information within 30 days of purchase.

This form has details of our guarantee terms & conditions so please read it carefully, fill it in and return it to the address at the back of this manual.

Alternatively you can register online at [www.taneasyprotools.com](http://www.taneasyprotools.com).

Keep this form, with your original proof of purchase for any claim under guarantee.

If you have any queries or require further information on your product please contact your local representative of Tan.Easy Pro Tools Products.

### GUARANTEE PERIOD BY PRODUCT

**2 YEARS** All products (Parts Only)

**LIFETIME GUARANTEE:** Handy.Tan Spray Gun

**PLEASE NOTE:** Shipping or return expenses are not covered.

### TERMS & CONDITIONS

If within two (2) years from the date of purchase, the product fails due to a defect in material or workmanship, we will repair if possible or replace it free of charge with a comparable unit, which may be new or refurbished. This guarantee applies only to the original purchaser and is not transferable. The goods must be returned to the seller with proof of purchase to be assessed at the purchasers cost. This excludes the Handy.Tan Spray Gun, which has a lifetime guarantee. Prior to making a claim, please ensure you have read all trouble-shooting questions at [www.taneasyprotools.com](http://www.taneasyprotools.com). If there is a defect with the device, it will be replaced free of charge with a comparable unit.

Guarantee shall not apply to any defect, failure or damage caused by improper use or improper or inadequate maintenance and care. The manufacturer shall not be obligated under this guarantee:

1. To repair damage resulting from attempts by personnel other than authorized representatives to install, repair or service the product.
2. To repair damage, malfunction, or degradation of performance resulting from improper use or incompatible solution.
3. To perform maintenance or cleaning or to repair damage, malfunction, or degradation of performance resulting from failure to perform user maintenance and cleaning as prescribed.
4. To repair damage, malfunction, or degradation of performance resulting from use of the product in an environment not meeting the operating specifications.

### EXTENDED WARRANTY

Tan.Easy Extended Warranties can be purchased anytime within the first 30 days of your product purchase through the website - [www.taneasyprotools.com](http://www.taneasyprotools.com).

Extended Warranty through Tan.Easy provides the peace of mind, certainty and convenience of having the whole repair/replace-ment process managed for you in respect of most mechanical and electrical failures, including failures caused by wear and tear, during the period of your Extended Warranty and after the expiry of the first 2 years Guarantee.

**PURCHASE YOUR EXTENDED WARRANTY ONLINE : [www.taneasyprotools.com](http://www.taneasyprotools.com).**

**REGISTER YOUR  
2 YEAR GUARANTEE**



# WARNING & SAFETY

## IMPORTANT SAFETY PRECAUTIONS

BEFORE USING THIS TAN.EASY PRODUCT, READ ALL INSTRUCTIONS AND CAUTIONARY MARKINGS IN THIS MANUAL AND ON THE DEVICE.

When using an electrical appliance, basic precautions should always be followed, including the following:

## WARNING

TO REDUCE THE RISK OF FIRE, ELECTRIC SHOCK, OR INJURY:

1. Do not leave product when plugged in. Unplug from outlet when not in use and before servicing.
2. Do not use outdoors or on wet surfaces.
3. Do not allow to be used as a toy. Close attention is necessary when used by or near children.
3. This product is not intended for use by persons (including children) with reduced physical, sensory or mental capabilities, or lack of experience and knowledge, unless they have been given supervision or instruction concerning use of the appliance by a person responsible for their safety.
4. Use this device only for its intended function and do not use attachments not recommended by the authorized Tan.Easy Pro Tools manufacturer.
5. Do not use the device if the cord is damaged. In the event of damage discontinue use immediately. If the supply cord is damaged, it must be replaced by the authorized Tan.Easy manufacturer.
6. If device is not working as it should, has been dropped, damaged, left outdoors, or dropped into water, do not use, contact Tan.Easy Pro Tools Customer Care via the website or regional telephone number.
7. Do not pull or carry by cable, use cable as a handle, close a door on cable, or pull cable around sharp edges or corners. Keep cable away from heated surfaces.
8. Do not unplug by pulling on cable. To unplug, grasp the plug, not the cable.
9. Do not handle plug with wet hands.
10. Do not put any object into openings. Do not use with any opening blocked; keep free of dust, lint, hair, and anything that may reduce air flow. Switch off and unplug the product before attempting to remove any blockage.
11. Turn off all controls before unplugging.
12. Do not spray flammable or combustible liquids, such as gasoline, or use in areas where they may be present.
13. Do not use without the filter in place.
14. Never look directly into the airflow when device is in use.
15. Do not use an extension cord unless the cord complies with local regional electrical safety standards
16. Periodically inspect the power cord for signs of damage

### SAVE THESE INSTRUCTIONS

This product is intended for professional use only.

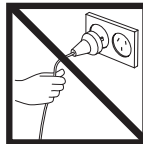

Do not pull  
on cable.

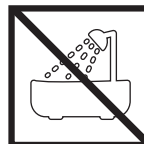

Do not submerge  
in water or get  
wet.



Do not use near  
open flames

## FOR MORE INFORMATION

ONLINE  
VISIT OUR WEBSITE FOR MORE INFORMATION  
[WWW.TANEASYPROTOOLS.COM](http://WWW.TANEASYPROTOOLS.COM)

